

OTTAWA

*A city rich with parks,
museums and historic sites,
this Capital City of
Canada also has an elegant
yet robust outlook on
business and pleasure.*

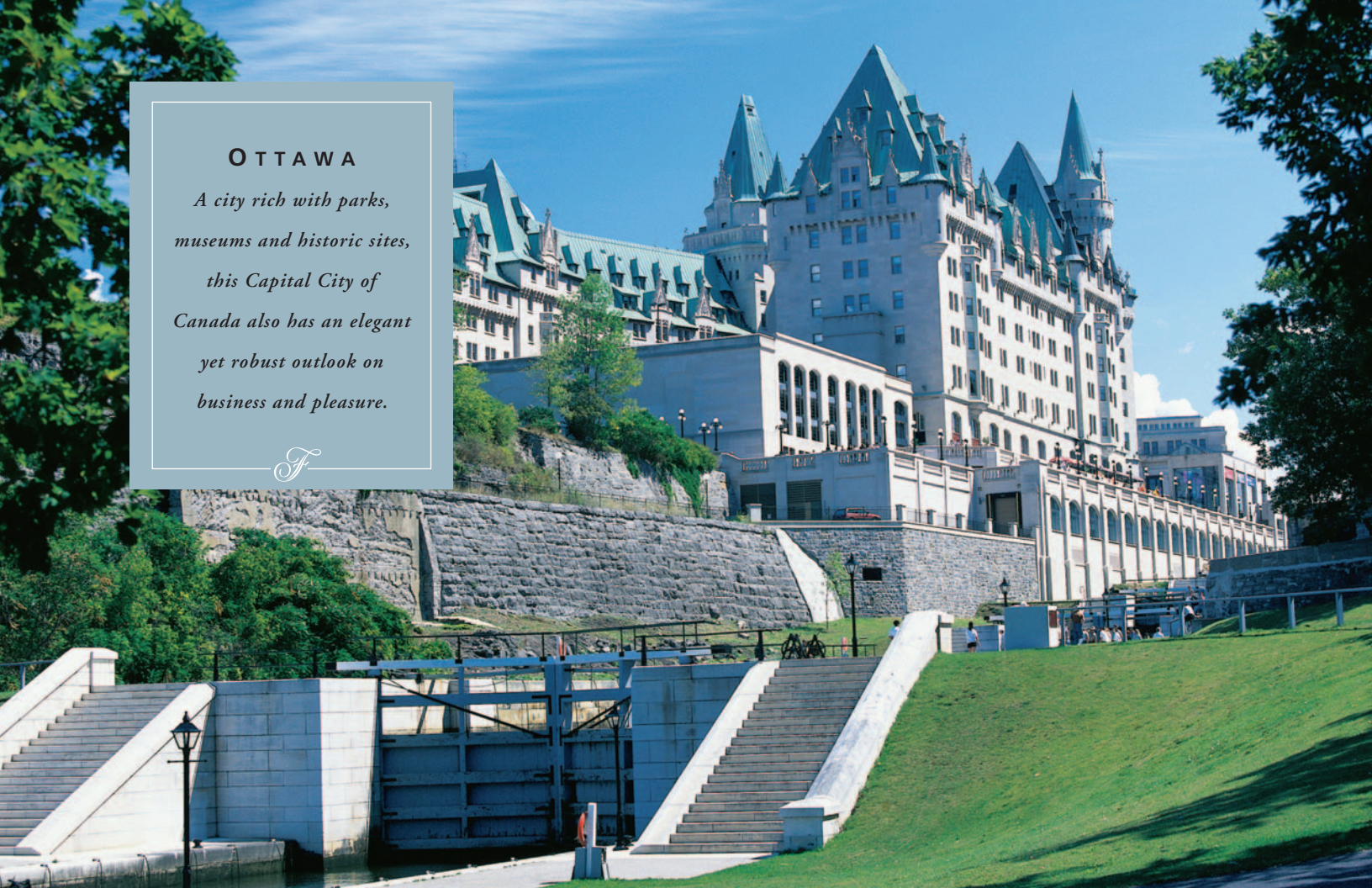

FAIRMONT CHÂTEAU LAURIER

Next door to the Parliament Buildings stands the Fairmont Château Laurier. A grand limestone building, with turrets and masonry reminiscent of a French castle, it is one of Ottawa's great landmarks. Recently renovated, the Fairmont Château Laurier reflects the confidence, dignity and style of Ottawa. Yet, more to the point, the Fairmont Château Laurier shares with the city a refined yet robust outlook on business and pleasure. Its meeting facilities are as functional as they are elegant. Over the years it has served as the stately home-away-from-home to both politicians and visiting royalty. Perfectly situated in the heart of the capital, it is close to the National Arts Centre, the new National Art Gallery and Museum of Civilization as well as the Ottawa Congress Centre.

1 Rideau Street
Ottawa, Ontario
Canada K1N 8S7
Telephone: 613-241-1414
Fax: 613-562-7033



Mezzanine

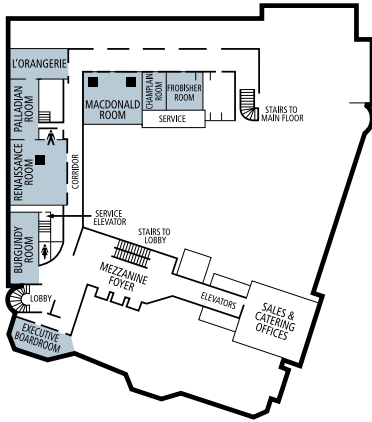

Lower Level

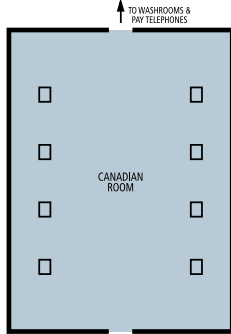

Ground Floor

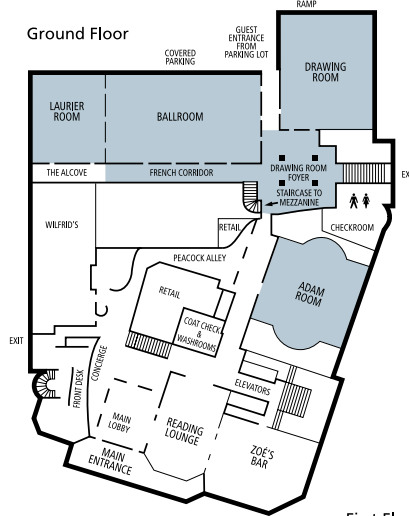

First Floor

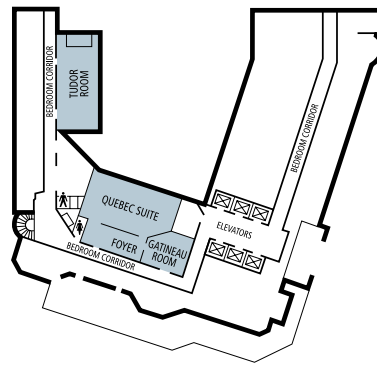

AVERAGE TEMPERATURES (Celsius/Fahrenheit)			
		°C/F	°C/F
		High	Low
WINTER	JANUARY – MARCH	-4/25	-15/5
SPRING	APRIL – JUNE	16/61	6/43
SUMMER	JULY – SEPTEMBER	25/77	13/55
FALL	OCTOBER – DECEMBER	10/50	-6/21

ROOMS

• Total Rooms	429
• Single	264
• Double	132
• Suites	33
• Non-Smoking	385
• Special Access	8
• Fairmont Gold	55

FACILITIES

- Airport – Ottawa International (10 miles/18 km)
- Rail Station – Ottawa (2 miles/3 km)
- Business Center
- 1 lounge and 1 restaurant, 1 seasonal Terrace
- 24-hour in-room dining
- In-room refreshment centers
- Health Club/indoor swimming pool
- Parking – indoor, 360 cars, outdoor and valet

ACTIVITIES

- See Activities Chart for more detailed information

LOCAL ATTRACTIONS

- Byward Market
- Canadian Museum of Civilization
- Casino du Lac Leamy
- Government Conference Centre (connected underground)
- National Gallery of Canada
- Parliament Hill
- Rideau Canal
- Rideau Centre – Shopping
- Winterlude (February)
- Canadian Tulip Festival (May)

ROOMS	OVERALL DIMENSIONS		SQUARE		HEIGHT		CLASSROOM	THEATER	RECEPTION	BANQUET ROUND X 10
	FEET	METERS	FEET	METERS	FEET	METERS				
GROUND FLOOR										
Ballroom	109' x 54'	33.2 x 16.4	5886	544.5	18'	5.4	375	500	800	500
Adam Room	94' x 55'	28.6 x 16.7	5170	477.6	23'	7	225	350	450	300
Drawing Room	63' x 57'	19.2 x 17.3	3591	332.2	14'	4.3	120	300	300	250
Laurier Room	56' x 48'	17 x 14.6	2688	248.2	16'	4.8	100	225	255	200
French Corridor	109' x 21'	33.2 x 6.4	2289	212.5	10'	3	–	–	250	–
Drawing Room Foyer	–	–	–	–	16'	4.8	–	–	200	–
MEZZANINE										
Burgundy	42' x 20'	12.8 x 6	840	76.8	9'	2.7	30	50	45	50
Renaissance	43' x 43'	13.1 x 13.1	1849	171.6	9'	2.7	60	115	175	100
Palladian	45' x 15'	13.7 x 4.5	675	61.7	9'	2.7	20	40	40	30
L'Orangerie	43' x 19'	13.1 x 5.7	817	74.7	9'	2.7	30	50	45	40
Macdonald	54' x 37'	16.4 x 11.2	1998	183.7	9'	2.7	80	115	150	100
Champlain	24' x 13'	7.3 x 3.9	312	28.5	9'	2.7	–	20	25	20
Frobisher	25' x 17'	7.6 x 5.1	425	38.8	9'	2.7	–	25	25	20
Executive Boardroom	40' x 18'	12.2 x 5.5	720	67.1	8'6"	2.6	20*	–	–	–
FIRST FLOOR										
Tudor	43' x 22'	13.1 x 6.7	946	87.8	10'	3	30	60	50	50
Québec Suite Foyer	46' x 19'	14 x 5.7	874	79.8	12'	3.6	–	–	80	–
Québec Suite Dining Room	60' x 26'	18.2 x 7.9	1560	143.8	12'	3.6	60	100	150	100
Gatineau	29' x 25'	8.8 x 7.6	725	66.9	10'	3	20	40	35	40
LOWER LEVEL										
Canadian Room	107' x 43'	33 x 13.2	4601	435.6	12	3.6	120	250	350	200

*Boardroom Style

Number of exhibit booths available upon request