

TORONTO

A city that has grown up around The Fairmont Royal York, so much so that the traditions of The Fairmont Royal York – those of charm, a sense of community and pride – are the traditions of Toronto.



THE FAIRMONT ROYAL YORK

Toronto is a city that has grown up around The Fairmont Royal York. Since 1929, the magnificent architecture of this landmark hotel has graced the city's skyline, and dominated the city's social scene. Now, more than 75 years later, the tradition of gracious hospitality at The Fairmont Royal York is stronger than ever. Our dedicated staff understand the needs of your guests, and draw on their breadth of experience to ensure every event is flawless. Our magnificently restored main lobby will awe your guests from the moment they arrive. They will appreciate the comforts of our guest rooms, furnished with traditional elegance, but equipped for the pace of today. They will enjoy the diversity of the meeting rooms in which you host events – from grand ballrooms with majestic chandeliers, to breakout rooms themed to Canada's provinces. The hotel is ideally situated to complete the Toronto experience – the CN Tower, Rogers Centre, Harbourfront, Entertainment District, and the Metro Toronto Convention Centre are just steps from our famous doors.

100 Front Street West
Toronto, Ontario
Canada M5J 1E3
Telephone: 416-368-2511
Fax: 416-368-9040



Main Mezzanine

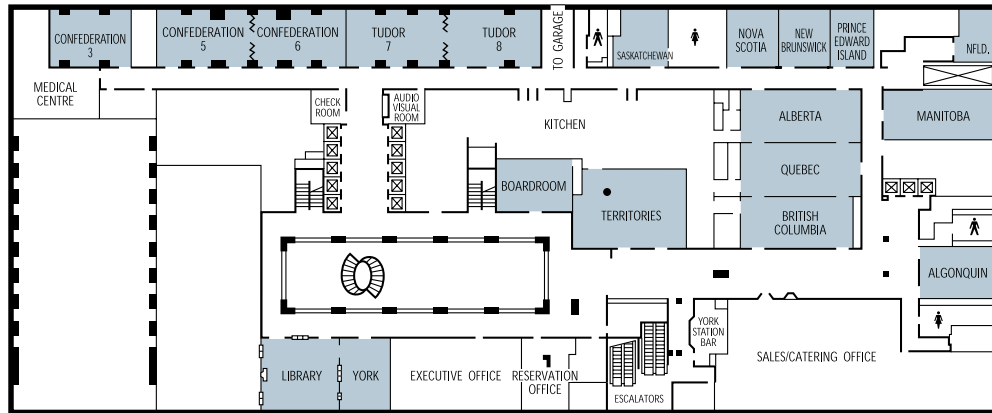

Convention Floor

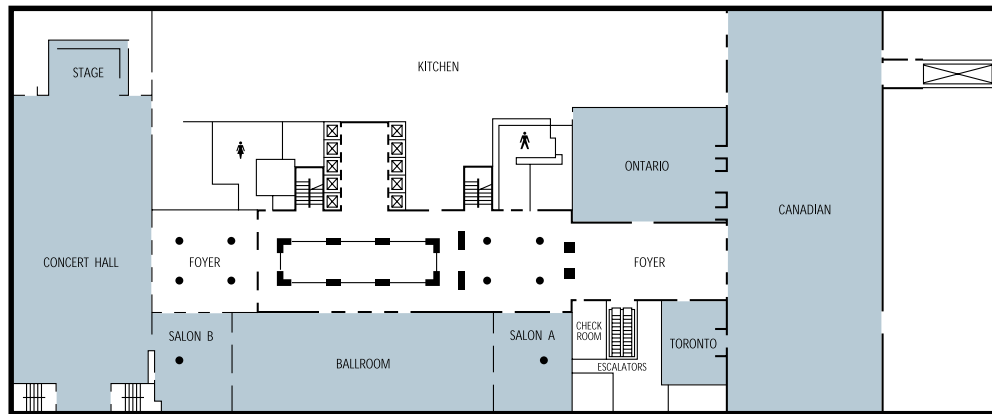

ROOMS	OVERALL DIMENSIONS		USABLE AREA		HEIGHT		BOARDROOM	CLASSROOM	THEATRE	RECEPTION	ROUNDS X10
	FEET	METRES	SQ. FEET	SQ. METRES	FEET	METRES					
MAIN MEZZANINE											
Newfoundland	22'11" x 23'8"	7 x 7.2	424	39.4	8'11"	2.7	14	12	36	40	20
Prince Edward Island	18'9" x 24'10"	5.7 x 7.6	466	43.29	10'	3	16	12	42	50	30
New Brunswick	22'11" x 24'10"	7 x 7.6	568*	52.8	9'9"	3	18	24	55	59	40
Nova Scotia	23' x 24'10"	7 x 7.6	571	53	10'	3	18	24	55	59	40
Saskatchewan	25'10" x 24'9"	7.9 x 7.6	589	54.7	8'6"	2.6	18	24	50	59	40
Tudor 7	24'4" x 45'6"	7.4 x 13.9	1076	99.9	10'10"	3.3	38	55	120	140	70
Tudor 8	24'8" x 47'5"	7.5 x 14.3	1128	104.8	10'10"	3.3	38	55	125	150	80
Tudor 7 & 8	24'7" x 93'2"	7.5 x 28.4	2195	204	10'10"	3.3	86	114	245	290	170
Confederation 3	27'7" x 38'7"	8.4 x 11.8	1009	93.8	9'5"	2.9	32	45	116	130	60
Confederation 5	27'7" x 49'6"	8.4 x 14.9	1183	110	8'11"	2.5	38	55	135	160	80
Confederation 6	27'7" x 26'10"	8.4 x 7.9	652	60.6	8'11"	2.5	24	29	65	85	40
Confederation 5 & 6	27'7" x 76'9"	8.4 x 23.2	1950	170	8'11"	2.5	68	90	210	250	130
Library	31'6" x 35'5"	9.6 x 10.8	1126	104.6	11'	3.6	32	54	114	135	90
York	22'9" x 32'	6.9 x 9.7	726	67.4	10'10"	3.1	26	33	55	59	50
Territories	35'7" x 51'6"	10.8 x 15.7	1833	170	9'5"	2.9	42	78	176	180	110
The Boardroom	23'6" x 34'7"	7.2 x 10.6	746	69.3	9'11"	3	24				
British Columbia	23'3" x 51'7"	7.1 x 15.7	1150	106.8	9'7"	2.9	44	64	130	160	80
Quebec	23'8" x 56'3"	7.2 x 17.1	1322	122.8	10'	3	48	76	135	175	80
Alberta	24'4" x 56'7"	7.4 x 17.2	1348	125.2	9'6"	3	50	76	135	170	80
Algonquin	22'10" x 37'11"	7 x 11.6	856	79.5	9'5"	2.9	30	48	85	105	70
Manitoba	22'5" x 55'3"	6.8 x 16.8	1214	112.8	9'6"	2.9	48	72	125	160	90
CONVENTION FLOOR											
Canadian	70'11" x 186'10"	21.6 x 56.9	12843	1193	21'7"	6.5	-	748	1460	1670	1260
Ontario	51'5" x 62'9"	15.7 x 19.1	3211	298.3	17'7"	5.4	60	168	384	405	280
Toronto	28'9" x 37'8"	8.8 x 11.5	839	78	7'11"	2.4	30	36	90	135	60
Salon A	36'10" x 40'6"	11.2 x 12.4	1383	128.5	11'	3.3	30	66	140	170	90
Ballroom	41'5" x 121'3"	12.6 x 37	4900	455.3	24'5"	7.4	84	300	480	590	440
Salon B	34'2" x 40'6"	10.4 x 12.3	1383	128.5	11'2"	3.4	30	66	136	165	100
Concert Hall	67'8" x 166'4"	20.6 x 50.7	8396	780	23'7"	7.2	-	540	1014	1085	740
<small>Stage Dimensions 34'6" w x 23'0" Curtain Opening 30'6" w</small>											
MAIN FLOOR											
Imperial Room*	62'11" x 96'2"	19.2 x 29.3	5991	556.6	21'8"	6.6	40	260	430	650	330
18TH FLOOR											
Upper Canada*	27'11" x 99'5"	8.3 x 30.3	2699	250.7	9'3"	2.8	84	118	260	290	200
1ST FLOOR HOSPITALITY SUITES											
Banff 1-263	40'2" x 14'7"	12.2 x 4.5	574	53.3	8'2"	2.5	32	24	48	60	30
Whistler 1-264	40'1" x 14'8"	12.2 x 4.5	576	53.5	9'2"	2.8	32	24	48	60	30
Montebello 1-265	38'10" x 14'8"	11.8 x 4.5	558	51.8	8'3"	2.5	30	21	48	60	30
Jasper 1-266	36'8" x 14'8"	11.2 x 4.5	531	49.3	8'4"	2.5	30	21	48	60	30
<small>***Dedicated Seating</small>											
<small>Banquet capacities are with rounds of 10</small>											

AVERAGE TEMPERATURES (Celsius/Fahrenheit)			
		°C/F High	°C/F Low
WINTER	JANUARY - MARCH	0/32	-6/21
SPRING	APRIL - JUNE	22/72	7/45
SUMMER	JULY - SEPTEMBER	24/75	16/61
FALL	OCTOBER - DECEMBER	10/50	-4/25

ROOMS

- Total Rooms 1,365
- Twin 36
- Double/Double 372
- Queen 340
- King 357
- Suites 187
- Non-Smoking 1,149
- Special Access 23
- Fairmont Gold 85

FACILITIES

- Airport - Toronto - Lester B. Pearson International (20 miles/32 km)
- Rail Station - Toronto (connected underground)
- Work Centre @ RYH and Xerox Business Centre
- 4 lounges and 5 restaurants - capacity 24 to 220
- 24-hour in-room dining
- In-room refreshment centres
- Health Club/indoor swimming pool
- Spa
- Parking - indoor, valet and outdoor (nearby)

ACTIVITIES

- See Activities Chart for more detailed information

LOCAL ATTRACTIONS

- CN Tower
- Harbourfront
- Hockey Hall of Fame
- Rogers Centre
- Toronto's Entertainment District

Note: The above room capacities represent the absolute maximum capacities for each room. They do not take into account space required for head tables, audio-visual equipment, food stations, or any other additional set-up. Please speak with your sales or service representative for the optimum room capacity for your event.

THE FAIRMONT ROYAL YORK • CITY HOTELS CANADA
 — THE NINETEENTH FLOOR EXECUTIVE MEETING ROOMS

One of the most exclusive and private selections of meeting rooms in Toronto, The Nineteenth Floor was designed in consultation with senior meeting planners and top level executives, and occupies the magnificently restored 19th and 20th floors of The Fairmont Royal York. The results of this consultation make The Nineteenth Floor an exemplary locale — available only to guests of The Fairmont Royal York — for executive meetings of 10 to 50 attendees.



SALONS	SQ. FEET	SQ. METRES	BOARDROOM	CLASSROOM	THEATRE	RECEPTION	U-SHAPE	ROUNDS X 10
Salon 1	1104	102.56	32	39	63	75	35	—
Salon 2	629	58.44	24	28	36	50	26	—
Salon 3	646	60.02	24	28	36	50	26	—
Salon 4	560	52.02	16	21	30	40	—	—
Salon 5	338	31.4	13	—	—	—	—	—
Salon 6	518	48.12	21	21	28	30	—	—
Salon 7	364	33.82	13	—	—	—	—	—
Salon 8	352	32.7	12	12	15	20	—	—
Salon 9	224	20.81	4	—	—	—	—	—
Total	4735	439.89						

TECHNICAL FEATURES	SALON 1	SALON 2	SALON 3	SALON 4	SALON 5	SALON 6	SALON 7	SALON 8	SALON 9
Ceiling mounted high resolution screen	•	•	•	•	•	•	•	•	•
Sound system with ceiling mounted speakers	•	•	•	•	•	•	•	•	•
ISDN Lines	•	•	•	•	•	•	•	•	•
Lighting and screen remote controls	•	•	•	•	•	•	•	•	•
Lighting and screen manual controls	•	•	•	•	•	•	•	•	•
Voice lift system				•	•		•		
Three press feed wall stations	•			•					
White board / cork board	•	•	•	•	•	•	•	•	•