

A journey as unforgettable as the destination

Breathtaking views of rugged coastlines. Towering green forests. Soaring mountain summits. Marvel at the natural beauty on the journey to Whistler as you travel 90 minutes north of Vancouver by car or luxury coach along the stunning Sea-to-Sky Highway. Of course, there are other equally memorable ways of coming to Whistler. Travel by train to experience the elegance and leisurely pace of an earlier age, or by helicopter or float plane for truly unforgettable views of Howe Sound and the spectacular Coast Mountains.

FLYING TIMES (IN HOURS) TO VANCOUVER FROM

Vancouver International Airport (YVR) offers convenient worldwide access through all major carriers.

ATHENS	12.5	PARIS	9
CHICAGO	4	ROME	11
DALLAS	4.5	SAN FRANCISCO	2.5
FRANKFURT	9	SINGAPORE	16
HONG KONG	13	SYDNEY	18
LONDON	8.5	TOKYO	10
LOS ANGELES	3	TORONTO	4
MIAMI	6	WASHINGTON, DC	6
NEW YORK	5		



THE *Fairmont*
CHATEAU WHISTLER

THE *Fairmont*
CHATEAU WHISTLER

TAKE YOUR MEETINGS TO NEW HEIGHTS

4599 Chateau Boulevard
Whistler, British Columbia
Canada V0N 1B4
TEL +1 604 938 8000
FAX +1 604 938 2055
E-MAIL chateauwhistlerresort@fairmont.com
www.fairmont.com/whistler

For reservations contact:
1 800 441 1414 or visit www.fairmont.com

Chain Code: FA Sabre: 1609 Apollo: 17761 Amadeus: YWSCWR Worldspan: WHIPC



PRINTED IN CANADA (1106)

An unparalleled destination

The Fairmont Chateau Whistler unites business and pleasure—world-class facilities married with all the scenery and year-round activities of a majestic mountain location—to help your meetings reach their full potential. Whether you're organizing a seminar for 25 or a conference for 1,000, we're committed to exceeding your expectations and making your event a success. Our award-winning services and facilities feature grand ballrooms, intimate boardrooms and unique suites, and include over 32,000 square feet of flexible function space with multimedia capabilities, a comprehensive business centre and inspired west coast menus.

At The Fairmont Chateau Whistler, our attentive, experienced staff are here to ensure no detail is overlooked, so you can focus on what's important—getting down to business.

THE FAIRMONT CHATEAU WHISTLER (above)

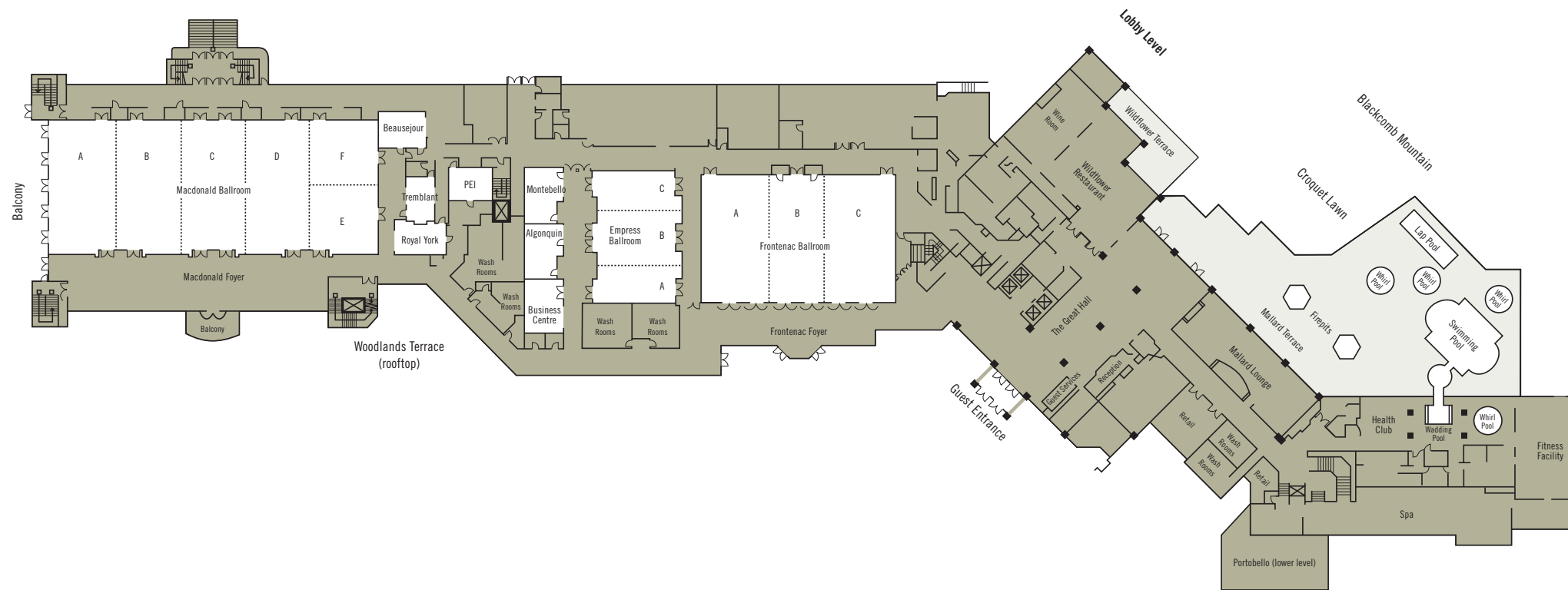

THE FAIRMONT CHATEAU WHISTLER

ROOMS	OVERALL DIMENSIONS		SQUARE		HEIGHT		CAPACITIES					
	FEET	METRES	FEET	METRES	FEET	METRES	BOARDROOM	CLASSROOM	THEATRE	RECEPTION	ROUNDS OF 8 U-SHAPE	
Frontenac	104' x 68'	31.70 x 20.73	7,072'	657.01	15'	4.57	102	338	738	589	424	127
Frontenac A	68' x 38'	20.73 x 11.58	2,584'	240.06	-	-	66	135	279	215	136	70
Frontenac B	68' x 28'	20.73 x 8.53	1,904'	176.89	-	-	66	108	207	159	112	65
Frontenac C	68' x 38'	20.73 x 11.58	2,584'	240.06	-	-	66	144	279	215	136	70
Front BC/AB	68' x 66'	20.73 x 20.12	4,488'	416.95	-	-	66	270	513	374	248	90
Frontenac Foyer	-	-	-	-	18'	2.87	-	-	-	150	128	-
Empress	68' x 43'	20.73 x 13.11	2,924'	271.65	9'7"	2.92	66	175	325	272	200	81
Empress A	43' x 20'	13.11 x 6.10	860'	79.90	9'4"	2.84	30	33	73	72	56	30
Empress B	43' x 28'	13.11 x 8.53	1,204'	111.86	9'4"	2.84	35	50	111	100	72	36
Empress C	43' x 20'	13.11 x 6.10	860'	79.90	9'10"	3	30	33	73	72	56	30
Empress BC/AB	48' x 43'	14.63 x 13.11	2,064'	191.75	15'	4.57	46	102	193	160	128	58
Empress Foyer	-	-	-	-	15'10"	4.83	-	-	-	50	-	-
Montebello	30' x 16'	9.14 x 4.88	480'	44.59	-	-	24	18	28	40	24	15
Algonquin	30' x 16'	9.14 x 4.88	480'	44.59	-	-	24	18	28	40	24	15
Royal York	27' x 14'9"	8.23 x 4.54	402'	37.37	-	-	14	N/A	N/A	N/A	N/A	N/A
Prince Edward	23' x 15'3"	7.01 x 4.66	352'	32.69	-	-	18	10	15	29	16	10
Tremblant	22'6" x 15'	6.86 x 4.57	338'	31.36	-	-	14	10	14	28	16	10
Beausejour	25' x 18'	7.62 x 5.49	450'	41.81	-	-	24	15	24	38	16	15
Macdonald	170' x 69'	51.82 x 21.03	11,730'	1,089.75	-	-	173	669	1410	1006	728	198
Macdonald A	69' x 34'	21.03 x 10.36	2,346'	217.95	-	-	67	138	229	196	144	60
Macdonald B	69' x 34'	21.03 x 10.36	2,346'	217.95	-	-	67	138	229	196	144	60
Macdonald C	69' x 34'	21.03 x 10.36	2,346'	217.95	-	-	67	138	229	196	144	60
Macdonald D	69' x 34'	21.03 x 10.36	2,346'	217.95	-	-	67	138	229	196	144	60
Macdonald E	34'6" x 34'	10.52 x 10.36	1,173'	109.02	-	-	33	51	99	98	64	35
Macdonald F	34'6" x 34'	10.52 x 10.36	1,173'	109.02	-	-	33	51	99	98	64	35
Macdonald Foyer	-	-	-	-	-	-	-	-	-	400	-	-
Hospitality Suites (5)	27' x 28'	8.23 x 8.53	756'	70.23	-	-	15	22	20	20	16	N/A
Woodlands Terrace	99'6" x 49'6"	30.33 x 15.09	4,925'	457.68	-	-	-	300	600	500	200	-

INTRODUCTION TO WHISTLER'S TRUE NATURE

On-site at The Fairmont Chateau Whistler, the Rooftop Woodlands Terrace, with its built-in fireplaces, barbecues, and a manicured herb garden, is a wonderful outdoor venue, ideal for welcome receptions and dinners. The large marquis tent holds group gatherings of up to 500 guests.

FEASTS OF CULINARY EXCELLENCE

Dining options at The Fairmont Chateau Whistler include The Wine Room's fine dining, The Wildflower's morning and evening classic style, Portobello's hip and casual deli and—the popular choice for visiting celebrities—The Mallard Lounge & Terrace. At the Mallard, guests can relax to live entertainment, sample the fine scotches and cigars in the exclusive Cigar Room, and stargaze outside around a roaring fire on the slopeside terrace.

Uniquely local tastes, such as “Tea at the Fairmont,” “Fondue at The Chalet” and exclusive dinners in The Wine Room's private Dining Room, highlight the perfect blend of authentic west coast cuisine and ambiance.

Creating delectable feasts for groups of 10 to 1,000, our Banquet Department and renowned culinary team of award-winning chefs present fresh and flavourful banquet dining—gala dinners in the ballroom, or four-diamond feasts at Lost Lake Park, the base of Blackcomb Mountain, or on a glacier—all with classic Fairmont flair!

AVERAGE TEMPERATURES
(Celsius/Fahrenheit)

	high °C/°F	low °C/°F
Winter	3/37	-5/23
Summer	27/80	11/52

- GENERAL INFORMATION**
- Time Zone Pacific Standard Time
 - Currency \$Canadian (CAD) dollar
 - Taxes 10% Hotel Tax
6% Goods and Services Tax (GST)
7% Provincial Sales Tax (PST)

- ROOMS**
- Total rooms 550
 - Fairmont 259, Deluxe 175, Suites 26
 - Fairmont Gold rooms & suites 65

- FACILITIES**
- Business centre
 - Championship golf course
 - Fairmont Gold (club level)
 - Health club and spa
 - Indoor/outdoor pools
 - 4 restaurants and lounge
 - Shops & art gallery

images from left to right
FAIRMONT KING ROOM, THE FAIRMONT CHATEAU WHISTLER GOLF COURSE, MACDONALD BALLROOM FOYER, SKIING AT WHISTLER AND MACDONALD BALLROOM