

## WINNIPEG

*Known for sunshine, blue skies and warm hospitality, Winnipeg's vibrant cultural diversity is reflected in its lively festivals, ethnic restaurants and numerous historical sites.*



## THE FAIRMONT WINNIPEG

Rest easy knowing your conference has been organized at The Fairmont Winnipeg. Over 20,000 square feet of meeting and banquet facilities accommodate up to 1,100, providing the most diverse and flexible meeting space of any downtown Winnipeg hotel. Guests enjoy our warm ambiance, exceptional service, and dining in the Velvet Glove—the only CAA/AAA Four Diamond rated restaurant between Toronto and Calgary—or unwinding in the Lounge at the Fairmont. You'll appreciate the hotel's immediacy to Winnipeg's vibrant arts and nightlife districts. Step outside and you are within minutes' walk of the Centennial Concert Hall, the historic Exchange District, The Forks, CanWest Global Park and the MTS Centre. The hotel's ideal location is further enhanced by its link to an indoor concourse of shops.

Two Lombard Place  
Winnipeg, Manitoba  
Canada R3B 0Y3  
Telephone: 204-957-1350  
Fax: 204-956-1791

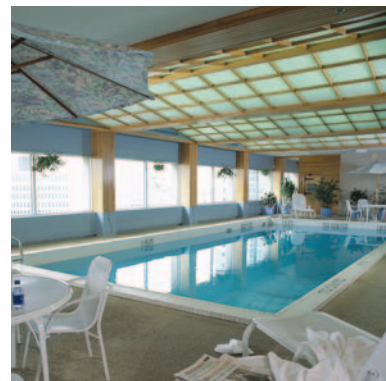

Mezzanine Level

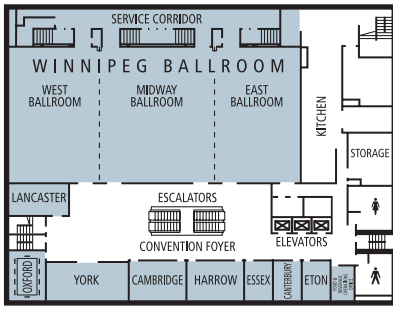

Concourse Level

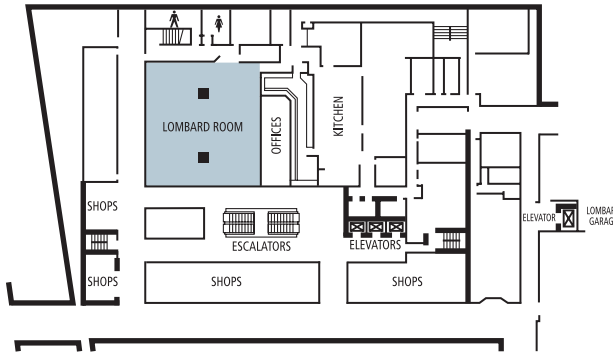

Lobby Level

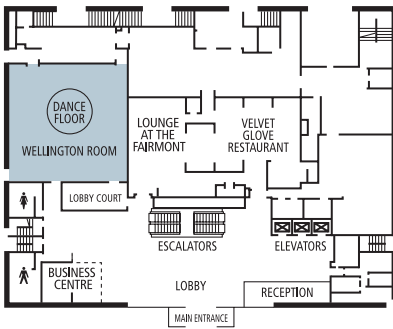

ROOMS	SIZE	SQUARE FEET	HEIGHT	THEATER STYLE		CLASS ROOM		BOARD ROOM	ROUND TABLE		DANCE & HEAD TABLE	RECEPTION	DANCE FLOOR
				N.HT	W.HT	N.HT.	W.HT.		N.HT.	W.HT.			
Winnipeg Ballroom West	65' x 143'	9295	14	1100	1000	-	-	-	850	800	600	1000	-
East	65' x 44'	2860	14	350	300	200	150	-	240	180	150	250	20x30
Midway	65' x 55'	3575	14	450	400	300	225	-	300	250	170	350	35x40
West	65' x 44'	2860	14	350	300	200	150	-	240	180	150	250	20x30
Wellington Ballroom**	55' x 55.5'	3052.5	12	350	300	180	140	-	250	190	140	250	400sq.ft
Lombard Room*	58' x 52'	3016	10	200	150	-	-	-	200	170	150	200	YES
HARROW, ESSEX & CANTERBURY	18' x 54'	972	10	100	90	60	50	50	70	60	-	80	YES
ESSEX & CANTERBURY	18' x 27'	486	10	50	40	30	25	30	30	-	-	40	-
Harrow	18' x 27'	486	10	50	40	30	25	30	30	-	-	50	-
Essex	18' x 14'	243	10	20	15	16	12	15	20	-	-	20	-
Canterbury	18' x 14'	243	10	20	15	16	12	15	20	-	-	20	-
York	18' x 40'	720	10	80	60	36	32	40	60	40	-	80	-
Cambridge	18' x 27'	486	10	50	40	30	25	30	30	-	-	50	-
Oxford	17' x 24'	408	10	-	-	-	-	10	-	-	-	-	-
Lancaster	14' x 28'	392	10	30	25	16	10	15	20	-	-	20	-
Eton	18' x 14'	243	10	20	15	20	10	10	10	-	-	15	-

\* Concourse Level  
\*\* Lobby Level

AVERAGE TEMPERATURES (Celsius/Fahrenheit)			
		°C/F	°C/F
		High	Low
WINTER	JANUARY - MARCH	-5/23	-15/5
SPRING	APRIL - JUNE	17/63	0/32
SUMMER	JULY - SEPTEMBER	30/86	17/63
FALL	OCTOBER - DECEMBER	7/45	-11/12

**ROOMS**

- Total Rooms 340
- Twin 6
- Double/Double 111
- Queen 55
- King 145
- Suites 20
- Non-Smoking 273
- Special Access 5

**FACILITIES**

- Airport - Winnipeg International Airport - (6 miles/10 km)
- VIA Rail Station - Winnipeg - (0.6 miles/1 km)
- Business Center
- 1 lounge and 1 restaurant - capacity 75 to 150
- Indoor rooftop pool and health club
- In-room refreshment centers
- Parking - outdoor and covered valet

**ACTIVITIES**

- See Activities Chart for more detailed information

**LOCAL ATTRACTIONS**

- The Exchange District
- Forks Market & National Historic Site
- Royal Winnipeg Ballet
- Assiniboia Downs Racetrack
- Winnipeg Symphony Orchestra
- Fort Whyte Centre
- Manitoba Theater Centre
- Lower Fort Garry National Historic Site
- The Festival du Voyageur
- Folklorama Festival
- Manitoba Museum of Nature
- Planetarium
- Centennial Concert Hall
- CanWest Global Park
- IMAX Theater
- MTS Centre